



TREEKEEPER™

WWW.TREEKEEPERBAGS.COM

For assistance with assembly or installation, parts and customer service:
www.TreeKeeperBags.com/Help | Support@VillageLighting.com

SLIM UPRIGHT TREE BAG

MODEL #: TK-10100
PATENT NO. US 7,694,494 B2

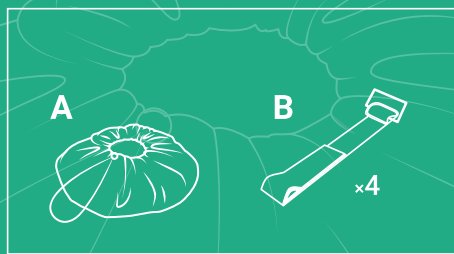

ATTACH TO YOUR STAND (SOLD SEPARATELY)

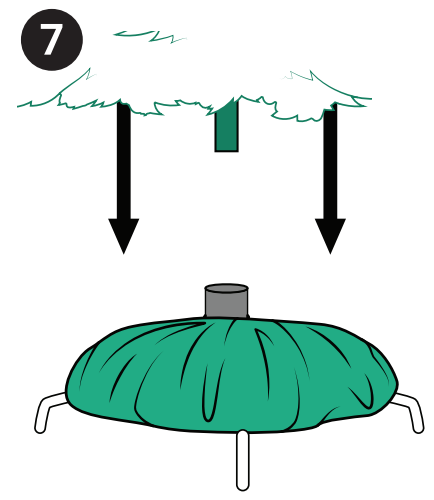
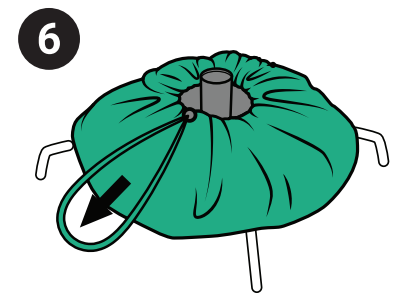
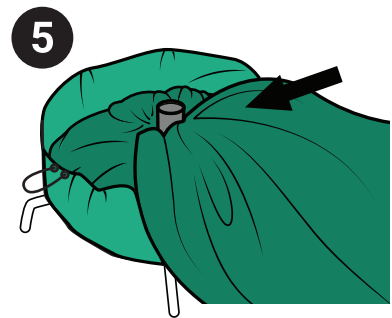
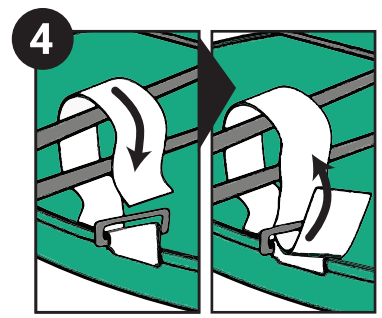
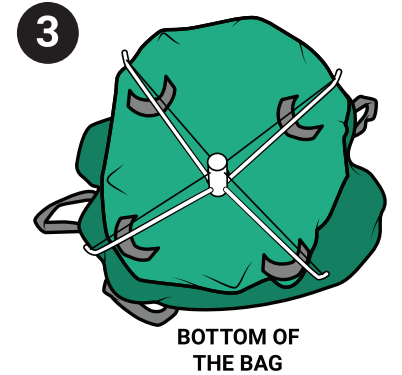
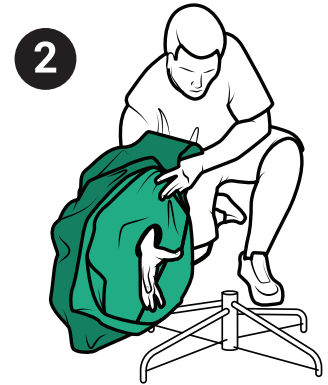
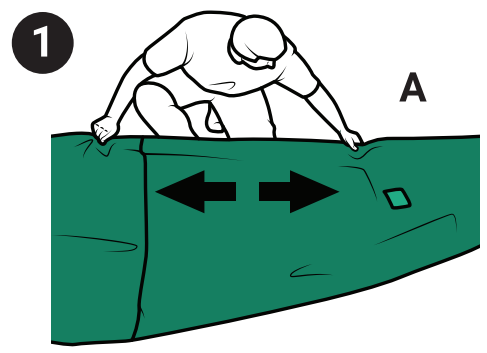

...CONTINUE TO NEXT PAGE FOR ADDITIONAL USAGE INSTRUCTIONS

IMPORTANT, RETAIN FOR FUTURE REFERENCE:
READ CAREFULLY

Intended for indoor use



TREEKEEPER™

WWW.TREEKEEPERBAGS.COM

For assistance with assembly or installation, parts and customer service:
www.TreeKeeperBags.com/Help | Support@VillageLighting.com

SLIM UPRIGHT TREE BAG

MODEL #: TK-10100
PATENT NO. US 7,694,494 B2

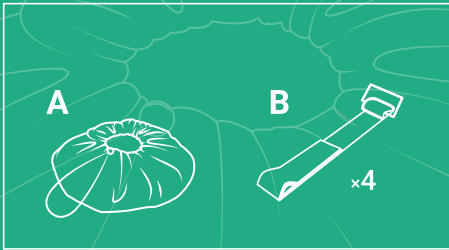

CAUTION



DO NOT lean the bag on its side and pull all the weight of the tree on one or two legs. Doing so could cause damage your tree stand, tree, or yourself. ALWAYS use caution when leaning the tree over.

DO NOT put too much pressure on the stand while tipped as this could result in damaging the trunk of the tree. Use CAUTION when lifting the tree as it may be heavy. Use EXTREME CAUTION when moving the tree up or down stairs. Whenever possible, USE TWO OR THREE PEOPLE TO STORE YOUR TREE.

STORING YOUR TREE

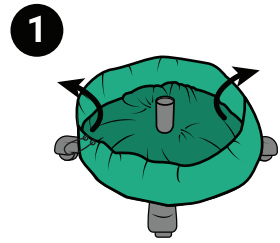

1 OPEN THE OUTER (LOWER) SKIRT

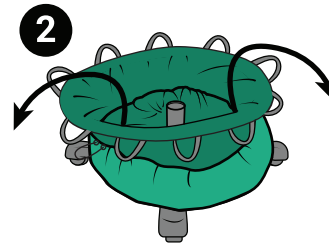

2 LOCATE AND PULL OUT THE TOP SKIRT OF THE BAG AND LAY FLAT AROUND THE TREE

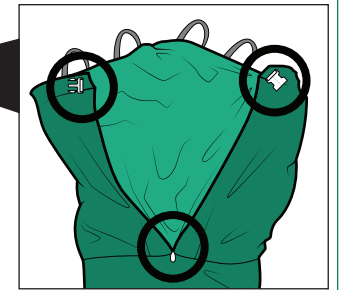
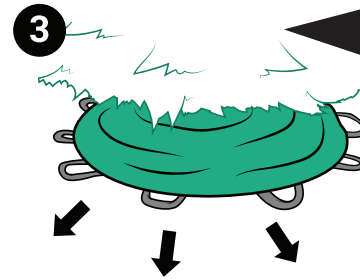

INSURE ALL BUCKLES, DRAWSTRINGS AND ZIPPERS ARE OPEN BEFORE PULLING UP

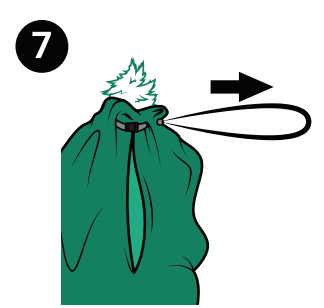
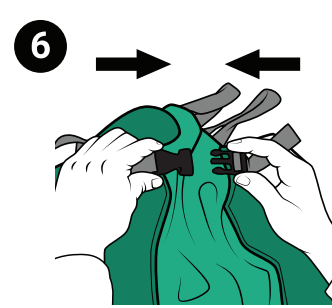

SETTING UP YOUR TREE AFTER STORAGE

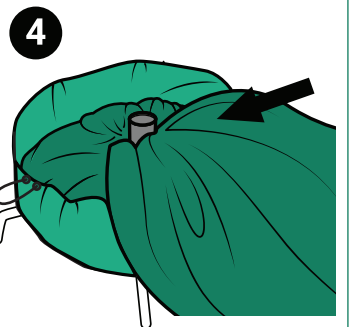
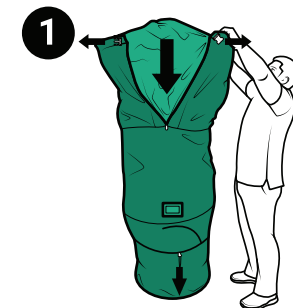

TREE BAG TROUBLESHOOTING, TIPS & FAQ

HOW THE UPRIGHT TREE BAG WORKS

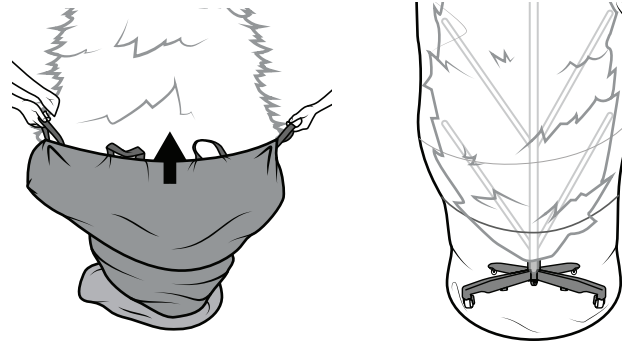

The bag pushes up on the hinged branches and compresses them into a vertical position. Sometimes the bottom branches are the hardest to get started because they're the largest.

MY TREE PULLS OUT OF STAND WHEN TRYING TO PULL THE BAG UP.



Make sure the knobs securing the tree are very tight.

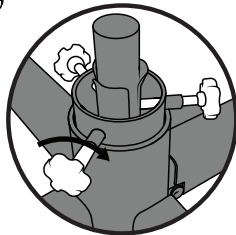

DOES IT SEEM LIKE YOUR BAG IS TOO SMALL?



Always Use 2 People



Make sure that all of the buckles and zippers on both sides are undone.



Start by pulling up on one side first, then work your way around to the other side.

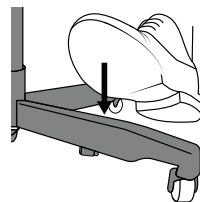

Apply pressure to the stand to keep it stable when pulling up.



Make sure the bag is not twisted when pulling up. Untwist and continue to pull up.

MY BAG IS STUCK! I CAN'T PULL IT DOWN TO SKIRT POSITION.



Let the skirt hang down as far as it can.



Make sure all the Buckles and Zippers are opened.



Reach your hand inside the bag and press the branch tips inward and tug down the bag to free it from the branches. Repeat this step and work your way around the tree.